



Technical Features



Range
Up to 4,2 m



Heating types
Heat pump
R32



Casing
Galvanised Steel
Self-Supporting



Airflow / Length
2190 - 5840 m³/h
1m to 3m



Heating capacity
10 - 27 kW



Grille type
Micro-perforated with
pre-filter included



Fans
EC Double Inlet
Centrifugal



Control
Plug&Play Advanced PRO
+ IR remote control
(Optional Clever Pro)



Outlet vanes
Airfoil type
Adjustable 0-15° each side

RAL 9016
standard



Stainless
steel



Other colors
on request



RUND is a cylindrical, elegant and exclusive air curtain that can be installed in horizontal or vertical position. The RUND air curtain has multiple finishes and configurations that make it the decorative solution suitable for any interior design project. Its energy saving heat pump compatible version achieves a reduction of up to 70% in consumption and CO₂ emissions (in heating mode).

Advanced Plug&Play control. Includes: Advanced PRO control with LCD display and integrated thermostat, door contact, 7m RJ11 cable and remote control. Requires MITSUBISHI ELECTRIC DX Interface KIT adapted for air curtain and programmable control, please consult.

Prepared for connection to MITSUBISHI ELECTRIC heat pump (R32/R410A) and expansion valve (not included), to be purchased by the customer.

Air curtain specifications

Model	Airflow m ³ /h	Fans power 230V-50/60Hz kW	Fans current 230V-50/60Hz A	Outdoor unit (*) 230Vx1	Outdoor unit (*) 400Vx3	Gas-Liquid pipe connections pulgada	Noise level (5 m) dB(A)	Weight kg
RUND ECG 1000 DX10-ME	2190	0,213	1,86	PUZ-ZM100VKA	PUZ-ZM100YKA	5/8" - 3/8"	61	50
RUND ECG 1500 DX14-ME	2920	0,284	2,48	PUZ-ZM125VKA	PUZ-ZM125YKA	5/8" - 3/8"	62	59
RUND ECG 2000 DX22-ME	4380	0,426	3,72	-	PUZ-ZM200YKA	1" - 3/8"	63	92
RUND ECG 2000 DX24-ME	4380	0,426	3,72	-	PUZ-ZM250YKA	1" - 1/2"	63	92
RUND ECG 2500 DX27-ME	5110	0,497	4,34	-	PUZ-ZM250YKA	1" - 1/2"	64	96
RUND ECG 3000 DX27-ME	5840	0,568	5,96	-	PUZ-ZM250YKA	1" - 1/2"	65	109

(*) Includes direct expansion valve. PUZ-ZM units with gas R32.

Also compatible with PUZ-M (R32) and PUHZ-ZRP, PUHZ-P, PUHZ-SHW (R410).

Outdoor unit specifications

Inverter model Outdoor Unit R32	Heating capacity kW	COP or SCOP	Cooling capacity kW	EER or SEER	Voltage	Gas-liquid pipes inch	Minimum pipe length m	Maximum pipe length m	Maximum pipe height m
PUZ-ZM100VKA	11,2	4,53	10	4,68	230Vx1	5/8" - 3/8"	-	100	30
PUZ-ZM100YKA	11,2	4,53	10	4,68	400Vx3	5/8" - 3/8"	-	100	30
PUZ-ZM125VKA	14	3,86	12,5	3,95	230Vx1	5/8" - 3/8"	-	100	30
PUZ-ZM125YKA	14	3,86	12,5	3,95	400Vx3	5/8" - 3/8"	-	100	30
PUZ-ZM200YKA	22,4	3,77	20	3,65	400Vx3	1" - 3/8"	-	70	30
PUZ-ZM250YKA	27	3,47	25	3,22	400Vx3	1" - 1/2"	-	70	30

When adverse weather conditions, the outdoor unit capacity can decrease. It is recommendable to oversize the units.



Technical Features



HEAT PUMP



Range
Up to 4,2 m



Heating types
Heat pump
R410a



Casing
Galvanised Steel
Self-Supporting



Airflow / Length
2190 - 5840 m³/h
1m to 3m



Heating capacity
10 -29 kW



Grille type
Micro-perforated with
pre-filter included



Fans
EC Double Inlet
Centrifugal



Control
Plug&Play Advanced PRO
+ IR remote control
(Optional Clever Pro)



Outlet vanes
Airfoil type
Adjustable 0-15° each side

RAL 9016
standard



Stainless
steel



Other colors
on request



RUND is a cylindrical, elegant and exclusive air curtain that can be installed in horizontal or vertical position. The RUND air curtain has multiple finishes and configurations that make it the decorative solution suitable for any interior design project. Its energy saving heat pump compatible version achieves a reduction of up to 70% in consumption and CO2 emissions (in heating mode).

Advanced Plug&Play control. Includes: Advanced PRO control with LCD display and integrated thermostat, door contact, 7m RJ11 cable and remote control.

Requires MITSUBISHI ELECTRIC VRF Interface KIT adapted for air curtain with expansion valve and programmable control, please consult.

Prepared for connection to MITSUBISHI ELECTRIC VRF (R410A) outdoor heat pump unit (not included), to be purchased by the customer.

Air curtain specifications

Model	Airflow m ³ /h	Fans power 230V-50/60Hz kW	Fans current 230V-50/60Hz A	KIT VRF -	Gas-Liquid pipe connections inch	Noise level (5 m) dB(A)	Weight kg
RUND ECG 1000 VRF10-ME	2190	0,213	1,86	PAC-AH125M-J	5/8" - 3/8"	61	50
RUND ECG 1500 VRF13-ME	2920	0,284	2,48	PAC-AH125M-J	5/8" - 3/8"	62	59
RUND ECG 1500 VRF15-ME	2920	0,284	2,48	PAC-AH125M-J	5/8" - 3/8"	62	59
RUND ECG 2000 VRF20-ME	4380	0,426	3,72	PAC-AH250M-J	1" - 3/8"	63	92
RUND ECG 2000 VRF24-ME	4380	0,426	3,72	PAC-AH250M-J	1" - 1/2"	63	92
RUND ECG 2500 VRF25-ME	5110	0,497	4,34	PAC-AH250M-J	1" - 1/2"	64	96
RUND ECG 2500 VRF29-ME	5110	0,497	4,34	PAC-AH250M-J	1" - 1/2"	64	96
RUND ECG 3000 VRF29-ME	5840	0,568	4,96	PAC-AH250M-J	1" - 1/2"	65	109

(*) Includes direct expansion valve.

VRF-compatible models are as follows:

- City Multi - Y Series (Heat Pump)
- City Multi - R2 Series (Heat Recovery)

When adverse weather conditions, the outdoor unit capacity can decrease. It is recommendable to oversize the units.



Selection program



Dimensions

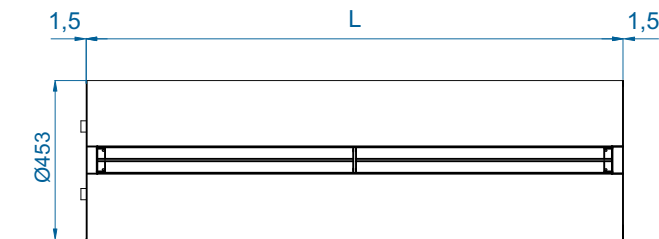

Model	L
1000	1025
1500	1525
2000	2030
2500	2530
3000	2980

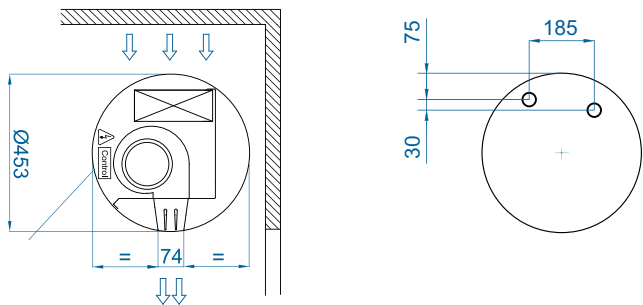

CAD drawings, BIM files, installation manuals and other documentation



Configurations and supports



Ceiling fixation through threaded rods



Wall/ceiling fixation through arms



Wall/ceiling fixation through angle supports



Wall fixation through lateral arms



Floor fixation (goalpost)



Accessories

Supports



Wall rail support
SPWR



Silentblock supports
SPANG-SIL / SLB



Gripple hanger
SPCT

Control



ADVANCED PRO
✓ Included



IR Control
✓ Included



RJ11 Cable
✓ Included



CLEVER PRO

Sensors



Magnetic door contact
DC
✓ Included



Mechanical door contact
DC